



MISSION ESSEX

Waterfront Project

Building for the gospel

City Church Chelmsford are developing a vacant historic building in the heart of Chelmsford to make space for our growing young church. We pray that Waterfront Place will become a vibrant and welcoming space for all of Chelmsford to see and hear the good news of Jesus Christ.





Pastor Jimmie Massie

To find out more about City
Church contact [jimmie@
citychurchchelmsford.com](mailto:jimmie@citychurchchelmsford.com)



Jimmie and family

City Church Chelmsford

4

History	4
Who Are We?	5
Mission	6
Activities	7
Testimonies of Impact	8

The Project

10

Location	10
Need	11
Building	12
Management	14
Progress So Far	15
Anticipated Future Timeline	15
Costs & Finance	18

Get Involved

16

Giving Form

17

Mission Essex

19

City Church Chelmsford

History

City Church Chelmsford was launched by Danbury Mission (DM) Church in 2020. DM Church was planted a hundred years before that by a local builder who shared the gospel in public and gathered a church in his home.

God has chosen to grow DM Church rapidly over the past thirty years, with many coming from the nearby city of Chelmsford. So DM Church launched City Church Chelmsford to meet the growing needs of an expanding city. The 33 adults in the “launch team” were forged

together by the Covid pandemic and, in October 2021, incorporated the former members of Broomfield Road Evangelical Church (BREC) and “re-launched” as one new church in the BREC building.

Today that building is full with about 130 attending Sunday gatherings; a third from DM, a third from BREC, and another third from elsewhere.



*Watch our video
about BREC joining
City Church
Chelmsford!*





Who Are We?

City Church Chelmsford and Danbury Mission are affiliated with the Fellowship of Independent Evangelical Churches (FIEC); a group of 650 churches across the UK.

fiec.org.uk

Locally we're the first initiative of "Mission Essex," a new collection of churches working together to plant and revitalise churches in our county (more on the back page).

Affiliated to **fiec** 
the Fellowship of Independent Evangelical Churches



*... we bring out the
timeless truths of
scripture for all ages*

Mission

We summarise the God-given mission of the church with the words “Reach, Build, Send”. To reach people with the saving message of Jesus, build them up his likeness, and send them out in his name and for his glory.

Our vision for 2022 was to see someone who wasn't a Christian become one. And we've been delighted to see God answer that prayer! Our vision for 2023 is to read the Bible with at least 10 people who are not yet Christians.

“They devoted themselves to the apostles’ teaching and to fellowship, to the breaking of bread and to prayer... And the Lord added to their number daily those who were being saved.” Acts 2:42,47





Activities

We celebrate the work of God in every area of life. And we believe this is our “front line” where God has placed to reach our neighbours and colleagues with the good news of Jesus.

Our main gathered activity is our Sunday meeting. We run a monthly prayer meeting. More than two-thirds of us gather in “home groups” that meet weekly for friendship, teaching, and pastoral support.

We run groups for young people up to age 18 and a daytime group for mothers with young children. We help to sponsor the local Christians Against Poverty Debt Centre and are involved with the Food Bank and two local university Christian Unions.

***“Whatever you do, whether in word or deed, do it all in the name of the Lord Jesus, giving thanks to God the Father through him.”
Colossians 3:17***

Testimonies of Impact

SAMUEL AWOLIYI

"The church have really shown they are more than a church and I look at them all as family. They have sent messages, dropped food off to us, prayed for us and continue to do so. The effort doesn't go unnoticed and we are truly humbled by it all."



LEAH MANSFIELD

"I was brought up in a Christian home. But it's only since coming to City Church that I came to believe myself. I've found the home groups very helpful and the Sunday services very encouraging."



“I was brought up in a Christian home. But it’s only since coming to City Church that I came to believe myself.”

ANDREW ASANTE

“Moving to a new area was difficult but the church in CCC were and are very welcoming and the teaching was gospel centred which helps keep the focus on Christ and the Father.”



PHILIPPA JESSOP

“I like the family feel and fellowship. I’m a student and I am really looked after. It’s like having family down here away from home.”



The Project



Location

Essex has a rich Christian history. It saw one of the first church plants in England, played a key role in the Reformation, sent out one of the first modern missionaries, and gave birth to Charles Spurgeon.

Today Essex is in the fastest growing part of the country. But it is spiritually poor with only 3% church attendance compared to a national average of 5% and 8% in London. Simply maintaining 3% attendance over the next ten years would require 30 new churches like ours! Reaching 5% attendance would require all existing churches to double in size!

Chelmsford is the “county town” and hub of Essex. We believe God

wants to establish City Church Chelmsford in the Waterfront Place building in the centre of Chelmsford. Waterfront Place is scenically located between a canal and the river Chelmer in the brand new Chelmer Waterside development. About 500 new homes have already been built with another 1000 planned over the next 10 years.

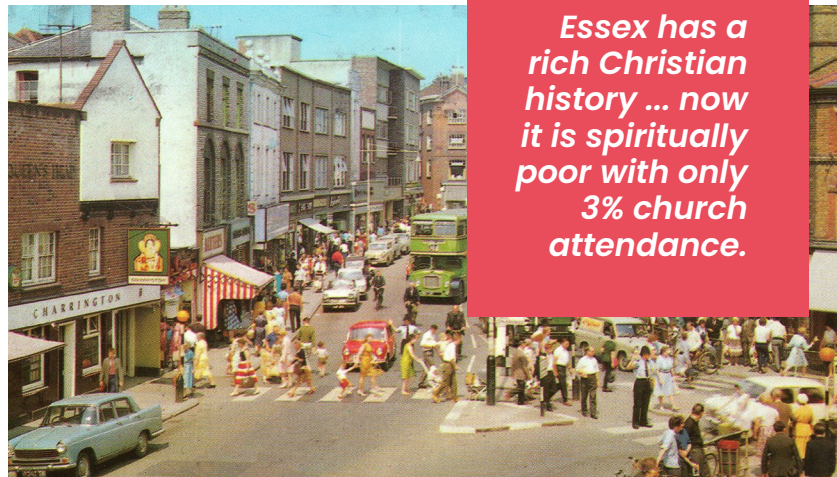

Essex has a rich Christian history ... now it is spiritually poor with only 3% church attendance.

Need

City Church Chelmsford need a larger meeting place! The current site cannot be developed due to its age, size, and location. Renting has proved difficult because of limited supply, increasing scepticism towards religious groups, and heightened caution following the pandemic.

A permanent meeting place would enhance our presence in the community. It would allow us to expand our daily ministry to young people, the poor, families and students in ways that renting would prohibit. A location in central Chelmsford would make us more accessible to our city and the county of Essex.

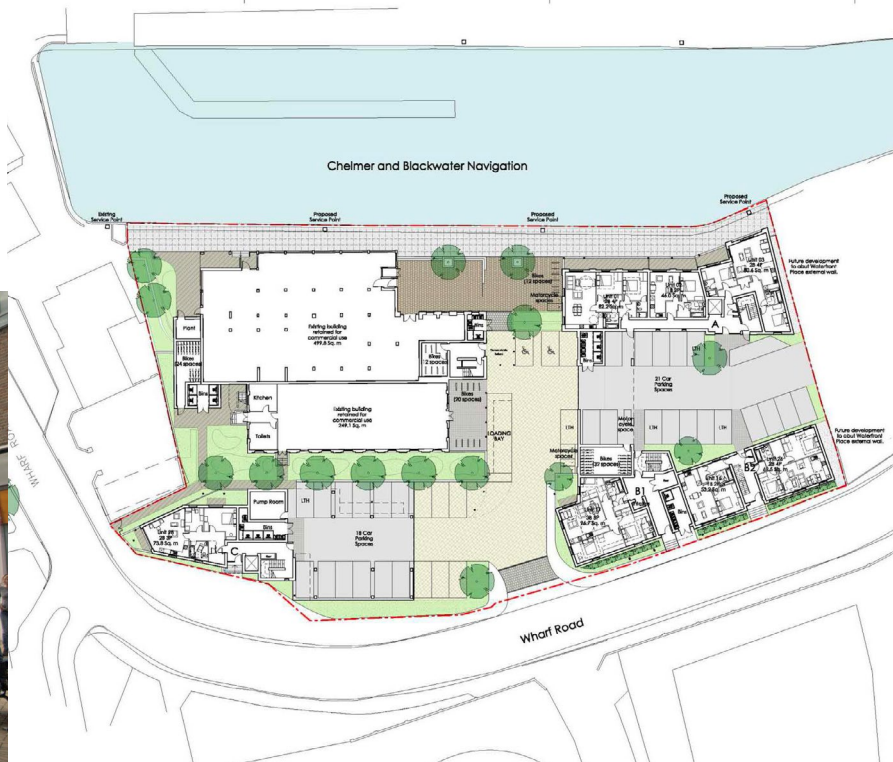



Building

Waterfront Place is an historic coal shed built over a hundred years ago for Chelmsford Gas Works. A modern extension was added thirty years ago to accommodate a popular restaurant. It has been vacant for the past ten years.

We have been granted planning permission to turn it into a church building with a hall for 230 people, a community space, kitchen, outdoor seating area, meeting rooms and offices.

Alongside the church will be a new coffee shop; the first community space in this growing new development.



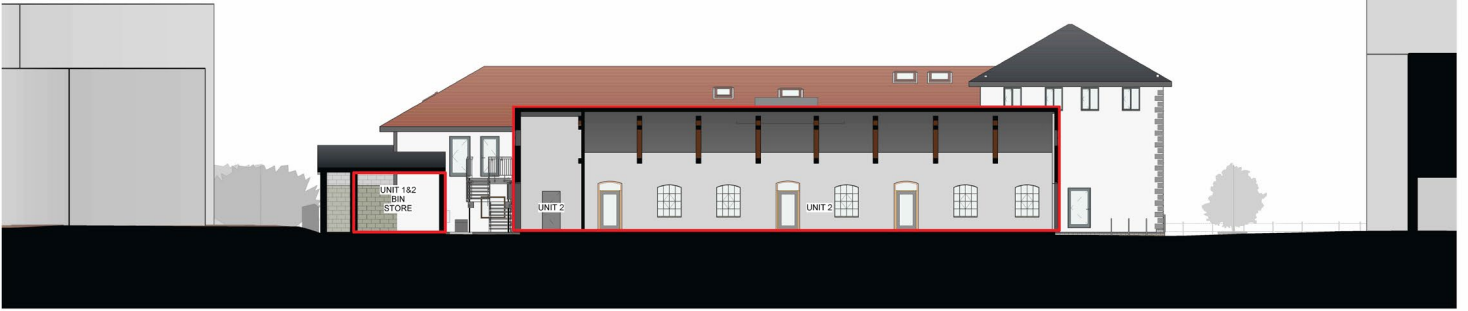

2 EXISTING LONG SECTION
1 : 100



1 EXISTING SHORT SECTION
1 : 100

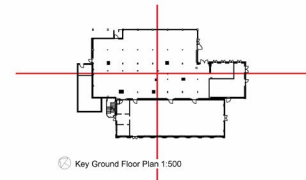

Key Ground Floor Plan 1:500



Management

City Church Chelmsford is a part of the Danbury Mission Church Charitable Incorporated Organisation. The charity is led by a joint team of elders for Danbury Mission Church and City Church.

The elders at Danbury Mission Church have led multiple building projects; including the £3 million redevelopment of their building ten years ago including a commercial quality coffee shop. The leadership team has a proven track record of planning and executing projects on this scale and are financially stable with 2022 general income of £703k, expenditures of £672k and available reserves of £232k.

The charity is governed by the Charities Commission in England and Wales, registration number 1179638. The constitution, charitable objectives, trustees and accounts are available on the Charity Commission website.









Danbury Mission Church Building



Hudson's Cafe at Danbury Mission

Progress So Far

- 
First viewing *Autumn 2020*
- 
Preliminary design proposals
Autumn 2021
- 
Funding for purchase secured
Winter 2021
- 
Offer accepted with conditions
Spring 2022
- 
Planning permission granted
Spring 2022
- 
Building surveys *Summer 2022*
- 
Conditional Contracts
Exchanged *July 2022*
- 
Design development
Autumn 2022
- 
Purchase completed
Spring 2023

Anticipated Future Timeline

from Feb 2023 ] 1 month

-  Design development
-  Preliminary works
Construction Information, Building control approval, Discharge planning approval, Party wall agreements, Bill of quantities, Identify suitable building contractors.
-  Tendering process
-  Appoint contractor
-  Contractor lead-time
-  Construction
-  Furniture and fittings
-  Handover and training

Move into building!

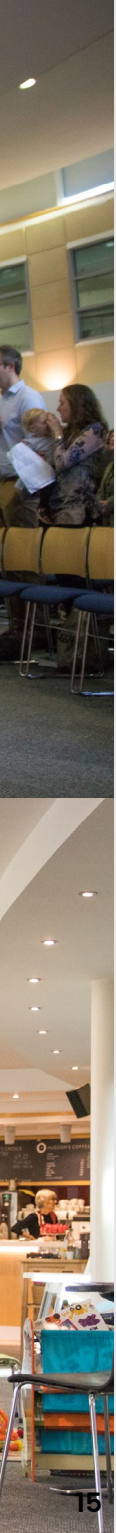

Get involved

*We long to see Chelmsford alive with the gospel again; to see people finding life in Jesus Christ; gathered into real community; young people established in their faith; the poor receiving financial and spiritual help; students growing to maturity; Christian leaders trained and sent out; struggling churches revitalised; new churches planted. **But we cannot meet these opportunities on our own.***

So we invite you to join us in this work of God; for the good of Chelmsford and the eternal glory of God.

If you'd like to support us by prayer, please sign up for our quarterly updates by emailing Jimmie Massie: jimmie@citychurchchelmsford.com

**We are seeking
£600,000 (\$720k)
in one-off giving
and an additional
£130,000 (\$160k)
per year over 3 to
5 years to help pay
back the loans.**

All donations are handled by Danbury Mission Church CIO. We would be grateful if you could notify us of any donations by completing the response form on the next page.

Please email our Fundraiser for more details: **barrie.dobson@danburymission.org.uk**



Giving Form

We/I would like to give a one off donation of £
via bank transfer/other:

We/I would like to start to give regularly towards this project: £
each month/year for a period of years via standing order/other:

Name

Date

Email (optional)

Please complete this form and return it to our Treasurer, Sally Harris.

Email: sally.harris@danburymission.org.uk **Post:** 54 Maldon Road, Chelmsford, CM3 4QL, United Kingdom.



UK Giving: stewardship.org.uk/pages/waterfront or contact our treasurer for bank details.



US Giving: Tax-deductible giving should be made via **Trustbridge Global: shorturl.at/bptHJ**.
IRS relief may be available according to personal circumstances.





We are committed to providing Chelmsford and Essex with Bible-centred churches and believe that now is the right time to do so. If you wish to donate then please make sure your donation is marked 'Waterfront'.

We will review this appeal in December 2024, should it fail to raise sufficient funds or if the appeal raises more than is required, the excess will be retained by the church for future use supporting Bible-centred teaching across Essex.

*All data is collected, stored and used in accordance with the church's **Privacy Notice**. We (Mission Essex, but specifically Danbury Mission Church and City Church Chelmsford) will use the information you provide here to set up and support agreed transactions, but may also use these details to keep in touch with you and send you information about our events and activities by post, by hand, telephone, email and/or SMS (text message).*





Costs

	Property costs (incl. VAT)	£937,720
	Legal, professional & consent fees	£340,000
	Refurbishment and building work	£2,190,000
	Fixtures and fittings	£240,000

**Total cost
£3.71 million**

Finance

Secured:

	Grant from The Charis Trust	£1,000,000
	Danbury Mission reserves	£110,000
	Loans (up to...)	£1,500,000

Needed:

	Donations	£600,000
	Sale of existing property	£500,000

We are seeking £600,000 (\$720k) in one-off giving and an additional £130,000 (\$160k) per year over 3 to 5 years to help pay back the loans.

**Total investment
£3.71 million**

Mission Essex



Mission Essex is a collection of churches working to share the good news of Jesus with Essex.

Essex was once a major gospel centre for England that saw one of the country's first churches planted, raised leaders like Charles Spurgeon, and sent missionaries like John Eliot and Thomas Hooker.

Today 2 million people live in Essex and it's the fastest growing part of the country. But only 3% are connected to a church. (The national average is 5%, with 8% in London).

Most have never heard the gospel and Christians often travel outside their local community to get to a church.

To simply keep up with population growth and sustain 3% attendance, we'd need 30 more church plants over the next 10 years.



We **support** pastors relationally with weekly meet-ups. We also support churches practically with their regulations, safeguarding, premises, etc.



We **share** what we can with one another. We host annual events for the whole network. We also host termly training nights on topics like youth work, home group, and worship music for our network.



We **send** people and resources to enable the planting of new churches and revitalisation of old churches across Essex.

missionessex.com/give
01245 227428